

RoVent[®] and RoVent[®] Jr.

Automated ventilator

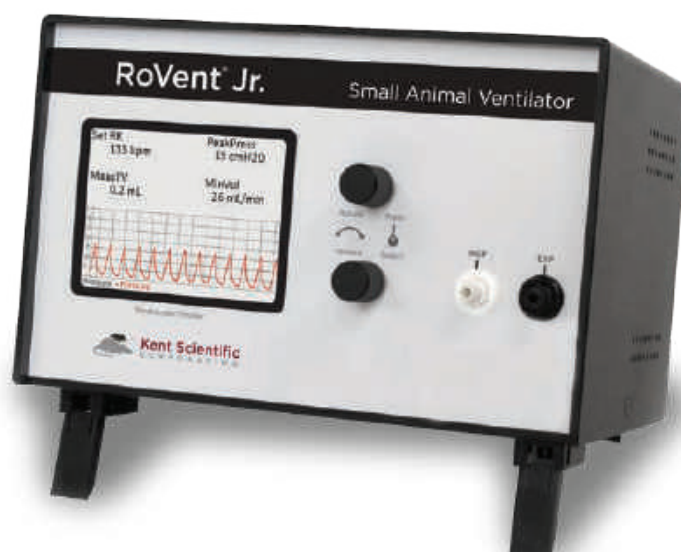
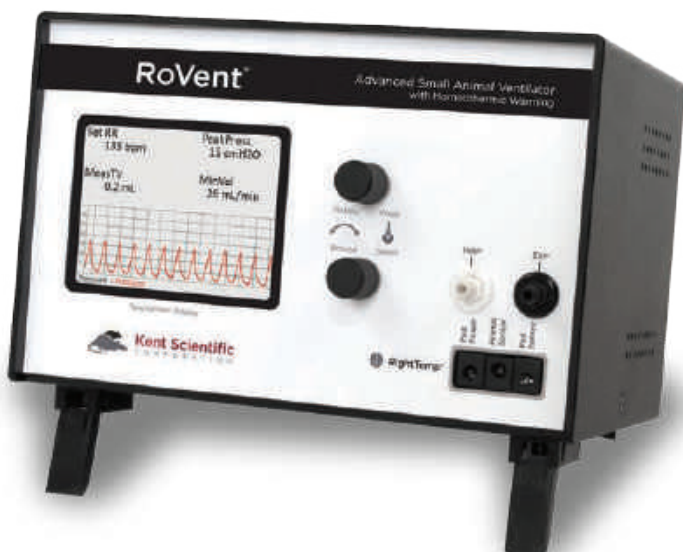

RoVent and RoVent Jr. small animal automated ventilator are ideal for mice, rats and small animals up to 1,250 grams. Both are fully automated — simply enter the animal's weight and press run.

The Rovent includes the RightTemp temperature monitor and homeothermic warming module.

Features & Benefits:

- **Fully automated with touchscreen control**
Safely ventilate using auto-calculated settings based on animal weight
- **Volume control and pressure control**
Reduce footprint with one, dual control ventilator
- **Multi-animal capability***
Greater efficiency

**Our clinical department will be pleased to review your study protocol to confirm that our product will meet your specific study requirements.*

1-Year 100% Parts & Labor Warranty (3-Year extended warranty available)

info@apacscientific.com
[Order.apacscientific.com/Australia & NZ](http://Order.apacscientific.com/Australia%20&%20NZ)

Order your ventilator from
sales@apacscientific.com

APAC
SCIENTIFIC



Kent Scientific
CORPORATION

Choose the ventilator that fits your research needs:

Comparison Chart RoVent® & RoVent® Jr.



	RoVent Jr. (\$1,895)	RoVent (\$3,975)
Volume ventilation	●	●
Pressure ventilation	●	●
Pulse ventilation mode	○	●
PEEP	○	●
Assist mode	○	●
Sigh breath	○	●
I:E ratio	●	●
Tidal volume – measured	●	●
Auto set-up	Limited	●
User profiles	○	●
Alarms (parameter)	○	●
Trigger in	○	●
Analog out	○	●
Digital out	○	●
Sync out	○	●
ADI integration	○	■
Data output	○	■
Internal data logging	○	●
Realtime clock	○	●
Temperature monitor and homeothermic control module	○	Included (valued at \$1,000)

Order your ventilator from
sales@apacscientific.com

APAC
SCIENTIFIC



Kent Scientific
CORPORATION

SomnoSuite[®]



Order your
SomnoSuite:

+61 (0)2 8814 1597
apacscientific.com

APAC
SCIENTIFIC



Kent Scientific
CORPORATION

Unlike traditional vaporizers, the SomnoSuite is designed with a precision syringe pump and integrated electronic vaporizer which uses either room air or compressed gas to deliver anesthesia at low flow rates proportionate to the animal's size. Using less anesthesia benefits the animal during procedures, and significantly reduces exposure of lab personnel to waste anesthesia gas. All SomnoSuites include a RightTemp® temperature monitoring and homeothermic control module.

All SomnoSuite systems include:

- Integrated display
- Real-time recordings
- 5 safety alarms
- Internal memory for data storage



- **Integrated electronic vaporizer**
Auto-calculates flow rate based on animal weight
- **Built-in air compressor**
Operates with room air or compressed gas
- **Flow rates from 25mL to 1L**
Requires less isoflurane
- **Intuitive touchscreen control**
Easy to use
- **Induction chamber flush**
Minimize exposure to waste anesthesia gases
- **Efficient design**
Compatible with stereotaxic devices
- **Modular capability**
Select modules for a variety of functions (see back cover for details)
- **Multi-animal capability***
Greater efficiency

**Our clinical department will be pleased to review your study protocol to confirm that our product will meet your specific study requirements.*

Easy Set-up

SomnoSuite with 2-accessory connector

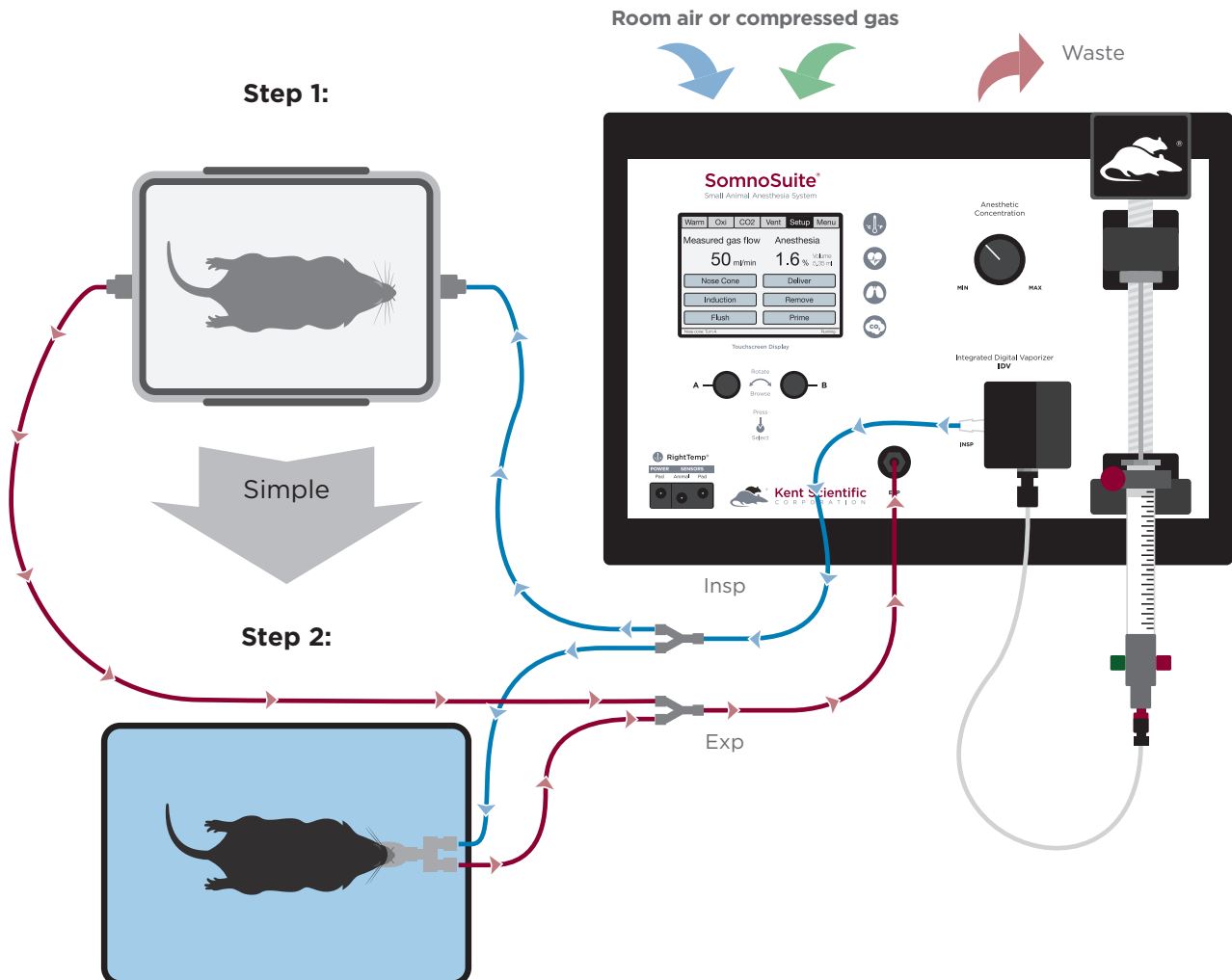

What makes SomnoSuite superior to traditional vaporizers?

Yearly operation savings (based on USA costings)

USAGE:	LOW		MEDIUM		HIGH	
	100 Hours of use/year		250 Hours of use/year		500 Hours of use/year	
						
	SomnoSuite	Traditional	SomnoSuite	Traditional	SomnoSuite	Traditional
Volume of Iso needed/year	2.4 Liters	24 Liters	6 Liters	60 Liters	12 Liters	120 Liters
Iso cost/year	\$340	\$3,360	\$840	\$8,400	\$1,680	\$16,800
Compressed gas cost/year	None	\$200 - \$300*	None	\$400 - \$600*	None	\$800 - \$1,200*
Total accumulated cost for all services	\$340	\$3,560 - \$3,660*	\$840	\$8,800 - \$9,000*	\$1,680	\$17,600 - \$18,000*
	You can save US\$3,320		You can save US\$8,160		You can save US\$16,920	

Precise anesthesia delivery



Less waste gas exposure

A recent dosimeter badge test was conducted between the SomnoSuite and a traditional vaporizer to measure waste gas exposure.

Both vaporizers were operated at their respective recommended flow rates. The results show nearly undetectable levels of exposure from the SomnoSuite vs. more than 3x above NIOSH guidelines for the traditional vaporizer.

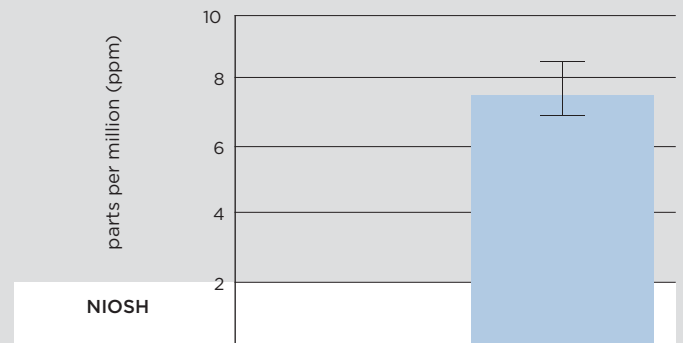

SomnoSuite®

Flow Rate	0 to 1 L/min
Syringe	5 mL and 10 mL glass syringes
Modes of Operation	Up to 4
Vaporizer	Internal Pump or Compressed Gas
Ventilator	Internal Pump or Compressed Gas
Max. Pusher Force	Greater than 36 kg
Carriage Position Detection	+/- 0.2 mm
Anesthetics	Isoflurane and Sevoflurane
Multi-animal capability*	Yes

Temperature Monitor & Homeothermic Control Module / RightTemp®

Resistance	2,252 ohm
Tolerance	+/- 0.2° C
Accuracy	25°C to 45°C
Operating Temp.	-40°C to 80°C
Sensor Diameter	Ball Tip Diameter: 1.65 mm max Shaft: 1.5 mm
Time Constant	10.0 seconds
Dissipation Constant	0.75 m/W (° C)

Pulse Oximeter & Heart Rate Monitor Module / MouseSTAT®

Heart Rate	Up to 900 bpm
Resolution	1%
SpO2 Range	70 to 100%
Alarms	5, Programmable
Data Export	Yes
SpO2 Sensors	Soft Touch Paw Sensors (standard) Large Animal Clip Sensors Pup Sensors MRI Sensors

Automated Ventilator Module / RoVent®

Control Modes	Volume Controlled, Pressure Controlled
I:E Ratio	1:1 to 1:5
PEEP	Built-in
Respiratory Assist	Automatic or Manual
Sigh Pressure	2 to 30 cmH2O
Sigh Breath	Automatic or Manual
Respiratory Rate Range	20 to 350 bpm
Max Inspiratory Flow	1.5 SLPM
Weight Range	3g to 1,250g
Multi-animal capability*	Yes

End-Tidal CO2 Monitor Module / CapnoScan®

Transducer Type	Sidestream Sensor
Sample Rate	50 mL/min. +/- 10mL/min.
Initialization Time	< 15 seconds
Measurement Range	0 to 16%, 0 to 120 mmHg
Rise Time	< 60 ms
Resolution	0.1 mmHg 0 to 69 mmHg 0.25 mmHg 70 to 150 mmHg
Accuracy	0 to 150 mmHg, 32 mmHg

*Our clinical department will be pleased to review your study protocol to confirm that our product will meet your specific study requirements.

SomnoSuite includes a **FREE RightTemp** temperature monitor and homeothermic control module.

Combine other modules you need now and add additional modules later

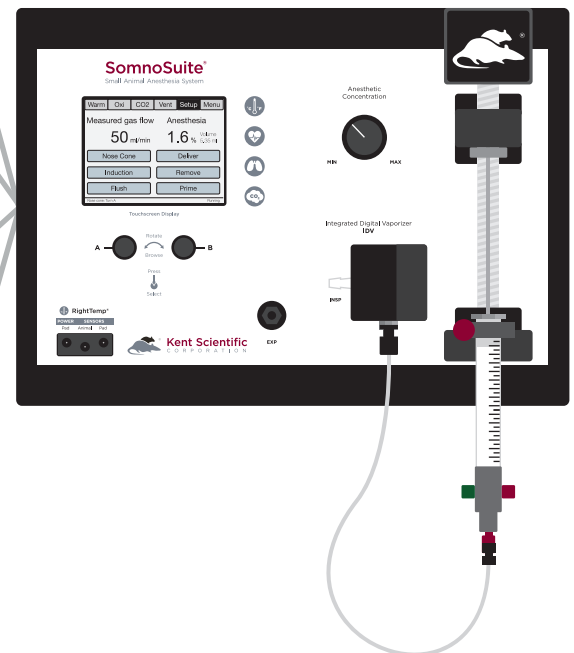

 **Kent Scientific**
CORPORATION

1-Year, 100% Parts & Labor Warranty (3-Year extended warranty available)

Available exclusively in Australia & New Zealand from:
APAC Scientific, Bella Vista 2153, NSW, Australia

Order your
SomnoSuite:

+61 (0)2 8814 1597
apacscientific.com

APAC
SCIENTIFIC



Mouse and Rat Intubation Kits



Aligned, illuminated, efficient

Features & Benefits:

- Integrated anesthesia facemask
Deliver isoflurane during intubation
- Neck positioner
Align airway structures
- Fiber optic lighting
Illuminate airway for enhanced visualization

APAC
SCIENTIFIC

Order your Intubation Kit:

info@apacscientific.com



Kent Scientific
CORPORATION

The intubation of small animals continues to be a challenge for researchers. With an integrated anesthesia mask, the Kent Scientific intubation kit allows the delivery of isoflurane during intubation, making it easier to intubate small animals.

The ability to adjust the angle of the neck allows alignment of airway structures to visualize the vocal chords.

Intubation kit includes:

- Intubation platform, positions animal at 60°
- Intubation stand with adjustable head positioning
- Anesthesia mask for anesthesia delivery during intubation
- Anesthesia mask tubing & connectors (36" length)
- Fiber optic light
- Intubation catheters (5-pack)
- Suture, 1-meter length
- Small spatula
- Small mirror
- Power supply

1-Year 100% Parts & Labor Warranty



The Intubation Tube Safety Wedge is designed to assist in insertion of the catheter into the trachea and minimizes the chances of inserting the cannula too deeply. During intubation, the wedge will guide the catheter tip to the proper location between the larynx and carina. Once placed, the tight fit ensures bilateral ventilation and reduces air leaks from around the catheter.



Integrate the SurgiSuite into your surgical set-up

Exclusively offered by APAC Scientific in Australia & NZ. Order your Intubation Kit:

info@apacscientific.com
apacscientific.com